



**INTERNATIONAL CONFERENCE**  
***Environment at Crossroads: SMART***  
***approaches for a sustainable future –***  
***ECOSMART***

November 2023  
**Bucharest, ROMANIA**



8:30 – 9:00 Registration

Room: LB, 3<sup>rd</sup> Floor

[09:00 – 09:30 Opening Ceremony](#)

Room: Valsan, 3<sup>rd</sup> floor

[09:30 – 11:00 Keynote Lectures](#)

Room: Valsan, 3<sup>rd</sup> floor

11:00 – 11:30 Coffee break

Hallway 3<sup>rd</sup> floor

11:30 – 13:45 Parallel Sessions

Room: Valsan, 3<sup>rd</sup> floor

[Topics: E. Challenges of Environment and Human Dimension \(English session\)](#)

Room: Mehedinti, 3<sup>rd</sup> Floor

[Topic: A. Applied Geomorphology](#)

Room: Bratescu, 3<sup>rd</sup> floor

[Topic: D. Water – Society – Environment](#)

Room: Mihailescu, 4<sup>th</sup> floor

[Topic: F. Recent Dynamics and Challenges of Territorial, Economic and Social Processes](#)

Room: Tempus, 4<sup>th</sup> floor

[Topics: E. Challenges of Environment and Human Dimension](#)

Room: Conea 3<sup>rd</sup> Floor

[Topic: G. Teaching Geography between tradition and modernity](#)

Room: 4A, 4<sup>th</sup> floor

[Topic: C. Monitoring the weather and climate to reduce their impacts and effects](#)

Room: 406, 4<sup>th</sup> floor

[Topic: H.01 SURE Workshop – Paradigm shift in urban ecology \(English session\)](#)

13:45 – 14:45 Lunch break

Hallway 3<sup>rd</sup> floor

14:45 – 17:00 Parallel Sessions / Workshops



Room: Valsan, 3<sup>rd</sup> floor

[Topics: E. Challenges of Environment and Human Dimension \(English session\)](#)

Room: Mehedinti 3<sup>rd</sup> Floor

[Topic: B. GIS, Remote Sensing and Geotechnology \(English session\)](#)

Room: Bratescu 3<sup>rd</sup> floor

[Topic: F. Recent Dynamics and Challenges of Territorial, Economic and Social Processes](#)

Room: Mihailescu, 4<sup>th</sup> floor

[Topic: F. Recent Dynamics and Challenges of Territorial, Economic and Social Processes](#)

Room: 406, 4<sup>th</sup> floor

[Topics: E. Challenges of Environment and Human Dimension](#)

Room: Conea 3<sup>rd</sup> floor

[Topic: H.03 Education Workshop – Bridging the Gaps in Geography Education](#)

Room: LA, 4<sup>th</sup> floor

[Topic: B. GIS, Remote Sensing and Geotechnology](#)

17:00 – 17:15 Closing Ceremony

Room: Valsan, 3<sup>rd</sup> floor



## 09:00 – 09:30 Opening Ceremony

Room: **Valsan, 3<sup>rd</sup> floor**

Opening Ceremony of the EcoSmart Conference

Rector of the University of Bucharest, Professor Marian Preda

Dean of the Faculty of Geography, Professor Alexandru Nedelea

On behalf of the Organizing Committee, Professor Mihai Răzvan Niță

Environment at Crossroads, Smart Approaches for Sustainable Futures

Contribution of the Faculty of Geography to development of the field

## 09:30 – 11:00 Keynote Lectures

Room: **Valsan, 3<sup>rd</sup> floor**

### **Adina-Eliza Croitoru**

*The vision of the World Meteorological Organization on research: from top-research to support for member states*

Faculty of Geography, Babes-Bolyai University; World Meteorological Organization, Research Board/Working Group on Research RA VI

### **Sorin Cheval**

*Climate-Resilient Development Pathways in Metropolitan Regions of Europe*

National Meteorological Administration; National Institute for Research and Development in Forestry "Marin Dracea"

### **Cristian Iojă**

*Centre for Environmental Research and Impact Studies - 30 years of advanced research in nature conservation and urban ecology*

Faculty of Geography, University of Bucharest



11:30 – 13:45 Parallel Sessions

Room: **Valsan, 3<sup>rd</sup> floor**

Topic: ***E. Challenges of Environment and Human Dimension*** (English session)

Moderators: **Gergely Tóth, Athanasios Gavriliadis**

**Marian Dumitru Mirea; Laurentiu Rozylowicz; Steluta Manolache; Iulia Viorica Miu; Lavinia Pîndaru; Viorel Popescu; Silviu Chiriac** - *Movement ecology of Hermit beetles (*Osmoderma eremita*) in Eastern Romanian Carpathians* (OP)

**Andreea Raluca Slave; Ana Maria Popa, Diana Andreea Onose; Simona R. Grădinaru; Ioan Cristian Iojă** - *Assessing the development of collaborative and adaptive approaches in strategic urban green space planning context* (OP)

**Mihai Răzvan Niță; Athanasios Gavriliadis; Cristian Ioan Iojă; Diana Andreea Onose** - *Evaluating how environmental challenges are approached in Romanian urban management* (OP)

**Mihai I. Pop; Cristian I. Iojă** - *Present and future challenges of human-wildlife interactions in urban areas* (OP)

**Ciobota Andreea; Ciobota Mihaela; Murariu Dumitru** - *Drivers of songbird species richness in four urban parks - Bucharest, Romania* (OP)

**Neagu Andra Claudia; Manolache Steluța; Rozylowicz Laurențiu** - *The drums of war are beating louder: Media coverage of brown bears in Romania* (OP)

**Gergely Tóth; Máté Novák; Anita Csordás; Tibor Kovács** - *Determination of the radium content in Transdanubian spring waters by liquid scintillation spectrometry* (PP)

**José G.Vargas-Hernández; Omar. C. Vargas-González** - *Entrepreneurial models of inclusive civil culture. The case of Zapopan Agro ecological Park* (PP)

**Nicu Alexandru Gîlea; Ileana Stupariu** - *Landscape permeability: a review analysis* (PP)

**Ileana Pătru-Stupariu; Cristian Iojă; Iuliana Vijulie; Mioara Clius; Andreea Ionescu** - *Analysis of young people's perception of human-wildlife interaction (positive/negative)* (PP)



11:30 – 13:45 Parallel Sessions

Room: **Mehedinti, 3<sup>rd</sup> Floor**

Topic: **A. Applied Geomorphology**

Moderators: **Laura Comănescu, Constantin Nistor**

**Constantin Nistor; Ionuț Săvulescu; Gabriela Toroimac; Sorin Carablaishă** - *The assessment of RUSLE model by bathymetric survey in an open system catchment* (OP)

**Iulian Săndulache; Rizac Alexandra; Săndulache Cătălina; Rașcu Mihaela; Tatu Florina; Oprea Răzvan** - *Siret Valley between Roman and Mărășești settlements – preliminary geomorphological approach* (OP)

**Vasile-Octavian Cosmescu** - *Analysis of Gleic Proluvosol Profile and Morphological Properties in the Vicinity of Vitomirești Village, Cotmeana Piedmont* (OP)

**Marina Virghileanu; Ionuț Săvulescu; Bogdan-Andrei Mihai; Monica-Gabriela Paraschiv; Carmen-Gabriela Bizdadea** - *Land use change effects on soil erosion: an integration between remote sensing and pedological approach towards sustainable soil-use solutions* (OP)

**Răzvan Popescu; Toma Hoinic; Alexandra Pană; Marius Rădulescu; Alexandra Rizac** - *Geomorphological and geophysical investigations for detection of undercooled talus slope deposits in Romanian Carpathians* (OP)

**Remus Prăvălie; Pasquale Borrelli; Mihai Niculiță; Bogdan Roșca; Cristian Patriche; Georgeta Bandoc** - *Geospatial modelling of land multi-degradation at global and European levels* (OP)

**Gabriela Osaci-Costache; Iuliana Armaș** - *Historical impact chains in Bucharest* (OP)

**Laura Comănescu** - *Romania's geoheritage – theoretical paradigm, legislation and the need for assessment* (PP)

**Adriana - Bianca Ovreiu; Constantin - Răzvan Oprea; Andreea Andra – Topârceanu** - *Spatio-temporal reconstruction of rockfall activity using dendrogeomorphological approach, in a forest stand in the Southern Carpathians* (PP)

**Valentin Jujea** - *Methodological context in the study of the geomorphological dynamics of the steep valleys in the Bucegi mountains* (PP)



11:30 – 13:45 Parallel Sessions

Room: **Bratescu, 3<sup>rd</sup> floor**

Topic: *D. Water – Society – Environment*

Moderators: **Gabriela Ioana Toroimac, Ionut Minea**

**Gabriela Adina Moroșanu; Gabriela Ioana-Toroimac; Liliana Zaharia; Cătălina Stoica; Dana Maria Constantin; Ionuț Andrei Șandor** - *Reaching several SDG indicators in ecological restoration projects: a comparative analysis between Comana Wetlands and Gilort River projects* (OP)

**Ionut Minea; Marina Iosub; Oana-Elena Chelariu; Daniel Boicu** - *Groundwater sources in Eastern Romania between climate changes impact and social vulnerability* (PP)

**Crina Radu; Mihaela Caian; Georgeta Bandoc** - *Characteristic and prognostic indicators of the breeze cell for the West coast of the Black Sea* (PP)

**Ana-Maria Roangheș-Mureanu; Amalia Mihaela Oglindoiu** - *Some aspects to regarding protection measures in spa tourism in Romania* (PP)

**Ioana Alexandra Mirea; Adriana-Gabriela Ilie; Răzvan Muntean; Robert Răzvan Dobre, Alexandru Nedelea; Mădălina Teodor; Laurențiu Andrei Ilie, George Alexandru Moțoiu** - *Analysis of the dynamics of the Ialomița River in the lower sector (Alexeni-Copuzu) during 1980-2017* (OP)

**Gabriela Ioana Toroimac; Gabriela Moroșanu; Ionuț Șandor; Dana Constantin; Cătălina Stoica** - *Revisiting the Hydromorphological Priority Restoration Index: bringing new evidence from field work on small rivers* (OP)

**Mihnea-Ștefan Costache; Liliana Zaharia** - *Multicriterial approach to map the hydropower potential in Romania* (OP)





11:30 – 13:45 Parallel Sessions

Room: **Mihailescu, 4<sup>th</sup> floor**

Topic: ***F. Recent Dynamics and Challenges of Territorial, Economic and Social Processes***

Moderators: **Andreea-Loreta Cercleux, Mihai Bulai**

**Andreea-Loreta Cercleux** - *Graffiti and street art, a tool for urban regeneration in Bucharest? (OP)*

**Liliana Popescu; Cristiana Vîlcea; Alin Clinea** - *Is Sustainable Development of Small Towns Viable amid Population Contraction? Romania as a Case Study (OP)*

**Cristina Lincaru; Vasilica Ciucă; Speranța Pîrciog; Adriana Grigorescu** - *Profiles of the dynamics of the mega trend of population aging at the county level in Romania for the next 50 years (OP)*

**Mihai Bulai; Lucian Roșu** - *Spatial and temporal dynamics of tourism areas in Romania facing the new crises (OP)*

**Alexandra-Lucia Zaharia; Amalia Niță; Andrei Schvab** - *The cultural-artistic concentration in Dolj County in the last decade (case study: The City of Craiova) (OP)*

**Andreea Guțu; Mihaela Preda; Iuliana Vijulie; Ana-Irina Lequeux Dincă** - *Residential satisfaction between tourism development and housing quality. Case study: Mamaia Nord, Județul Constanța (OP)*

**Florentina-Cristina Merciu; George-Laurențiu Merciu** - *The impact of the accelerated dynamics of services on the reuse of cultural heritage. Case study: urban protected area Căderea Bastiliei (Bucharest) (OP)*

**Ana-Maria Zaharia (Taloș); Florin-Alexandru Zaharia** - *Measuring geographical accessibility to general practitioners in Ialomița County (OP)*

**Bogdan Pălici; Liliana Dumitrache** - *Evolution of cultural infrastructure and the accessibility of public libraries (OP)*

**Iuliana Vijulie; Mihaela Preda; Ana-Irina Lequeux Dincă; Anca Tudoricu** - *The tourists' fascination for urban food markets – a new trend. Case study: Obor market, Bucharest (PP)*





11:30 – 13:45 Parallel Sessions

Room: **Tempus, 4<sup>th</sup> floor**

Topic: *E. Challenges of Environment and Human Dimension*

Moderators: **Marian Marin, Lavinia Corina Pîndaru**

**Lavinia Corina Pîndaru**; Laurentiu Rozylowicz; Steluta Manolache; Andreea Niță; Gabriel Ovidiu Vânău; Iuliana Viorica Miu; Cristiana Pioarcă-Ciocănea; Iulian Mihăiță Nicolae - *The impact and application of the Institutional Grammar Tool (IGT) in analyzing legislative documents* (OP)

Andreea Andra-Topârceanu; Sonia Malvica, Corine Corbeau; Alexandra Zaharia; **Marian Marin**; Radu-Daniel Pintilii; Graziella Benedetto; Enrica Corona; Donatella Carboni - *Involving local communities in assisting decisions regarding the Asinara Marine Protected Area* (Italy) (OP)

**Widad Al-Taha** - *Human impact in the Postavăru Massif. A multicriteria approach* (OP)

**Anca Georgiana Dinu**; Ileana Pătru-Stupariu - *The resilience of traditional agricultural landscapes influenced by political support tools* (OP)

**Alexandru Ovedenie** - *Analysis of precipitation quantities anomalies during the summers from 1970 to 2000 in Bucharest, influenced by the urban heat island effect* (OP)

**Ionuț-Marius Repede**; Teodor-Mihai Rotaru - *Imaterial Heritage visibility from Bucovina in social media* (PP)

**Cristina Cruceru**; Camelia Teodorescu; Florian Alin Butoi; Constantin Alexandru Lupuleț - *Historical monuments - support for tourism in the Gorj Subcarpathians; case study the city of Tg. Jiu* (PP)

**Mihăiță-Iulian Nicolae**; Gabriel-Ovidiu Vânău; Sorin Avram; Carmen Gheorghe; Cristiana-Maria Pioarcă-Ciocănea; Lavinia-Corina Pîndaru; Viorica Iuliana Miu - *Assessing the Romania's terrestrial protected areas network using connectivity metrics* (PP)



11:30 – 13:45 Parallel Sessions

Room: **Conea 3<sup>rd</sup> Floor**

Topic: **G. Teaching Geography between tradition and modernity**

Moderators: **Valentina-Mariana Manoiu, Mari-Elena Belciu**

**Florentina Toma** - *Effects of using learning activities in teaching geography (OP)*

**Valentina-Mariana Manoiu** - *Application of Ayurvedic profile in the educational process (OP)*

**Mari-Elena Belciu** - *Disciplina GEOGRAFIE, încotro? (OP)*

**Cristina Maria Popescu** - *Religious tourism in Bucharest - models of practical didactic approach (OP)*

**Mirela Chipaila** - *Necesitatea geografiei in promovarea conceptului de dezvoltare durabila in scoala (OP)*

**Mihaela Sima; Laura Lupu; Angelo Andi Petre** - *Teachers' perception on the implementation of „Green Week” National Programme in Bucharest (OP)*

**Mioara Clius; Daniel Vîrdol** - *The Green Week. How long is the road from theory to practice for schools in Romania? (OP)*

**Elena Coca Tudose** - *Geography teaching between traditional and modern (OP)*

**Leontina POPESCU; Lepădat-Marian POPESCU** - *Consilierea în carieră : provocări, realități și interpretări (OP)*

**Octavian Mândruț** - *A project for the management of the affirmation of geography in pre-university education (OP)*

**Roxana Cuculici; Constantin-Răzvan Oprea; Marian Ene** - *Collaborative learning, a modern form of teaching geography in higher education (PP)*



11:30 – 13:45 Parallel Sessions

Room: 4A, 4<sup>th</sup> floor

Topic: *C. Monitoring the weather and climate to reduce their impacts and effects*

Moderators: **Georgeta Bandoc, Lucian Sfică**

**Lucian Sfică; Pavel Ichim; Claudiu-Ștefănel Crețu; Vlad-Alexandru Amihăesei** - *Urban land use imprint on land surface temperature in the main cities of north-eastern Romania (OP)*

**Sorin Cheval; Vlad Amihăesei; Adina-Eliza Croitoru; Alexandru Dumitrescu; Csaba Horvath; Dana Micu** - *Observed variability and future projections of urban heatwaves in Romania (OP),*

**Dana Maria Constantin (Oprea); Nicoleta Ionac; Elena Grigore; Daiana Giorgiana Lüftner; Gabriel Raul Ilea** - *Aspects concerning the optimal precipitation requirement for winter wheat in the Extracarpathian area of the Meridional and Curvature Carpathians (Romania) (OP)*

**Georgeta Bandoc; Remus Prăvălie; Adrian Țișcovschi** - *Spatial analysis of global wind power potential (PP)*

**Adina-Eliza Croitoru; Zsolt Magyari-Saska; Csaba Horvath; Sorin Cheval** - *A new method to identify urban heat island hotspots (OP)*

**Isabelle Coiciu; Sorin Constantin Stegărescu** - *Microclimatic and Topoclimatic Characteristics of Bucharest Municipality. Case Study August 2023 (OP)*

**Andreea Nita; Stacey Fineran; Weston Fisher; Laurentiu Rozyłowicz** - *Assessing International Environmental Impact Assessment (EIA) Practices for Climate Change Adaptation (OP)*

**Dana Maria Constantin (Oprea); Adrian Amadeus Țișcovschi; Giorgiana Daiana Lüftner; Raul Gabriel Ilea; Gabriela Ioana Toroimac; Elena Grigore; Ionuț Andrei Șandor; Gabriela Adina Moroșanu; Cătălina Stoica** - *The observed changes in the precipitation regime in Romania – as a premise for the river restoration (PP)*



11:15 – 13:45 Parallel Sessions

Room: **406, 4<sup>th</sup> floor**

Topic: **H.01 SURE Workshop – Paradigm shift in urban ecology** (English session)

**11:15 – 11:30 – Introductory talks**

**11.30 – 12.00 – Invited presentations**

11.30 – 11.45 – Ecosystem services potential in the planning and management of urban areas. Case studies from Poznań, Poland, **Iwona Zwierzchowska, Piotr Lupa**

11.45 – 12.00 - Mapping blue-green infrastructure connectivity in the metropolitan area of Bucharest, **Antonio-Valentin Tache; Oana Cătălina Popescu; Alexandru-Ionuț Petrișor**

**12.00 – 13.30 - SURE South Eastern Europe and SURE Central Europe chapter – further research activities**

12:00– 12:30 - Creating urban green spaces which promote intergenerational equity

Project and discussion coordinated by assistant professor **Diana Onose**, University of Bucharest

12:30 – 13:00 - Socio-cultural integration of immigrants using urban nature

Project and discussion coordinated by Professor **Mihai Răzvan Niță**, University of Bucharest

13:00 – 13:30 – Nature integration in large commercial areas

Project and discussion coordinated by Professor **Cristian Ioja**, University of Bucharest

**13:30 – 13:45 – Further activity of the Society for Urban Ecology and concluding remarks**

13:30 – 13:35 - SURE Summer School\_İstanbul\_2024: Planning and Using Urban Ecological Spaces for Education – September 2024, Istanbul, **Meryem Hayir Kanat**

13:35 – 13:40 - SURE Congress, 2025, Istanbul – Progress, challenges and further activities, **Meryem Hayir Kanat, Cigdem Coskun Hepcan**

13:40 – 13:45 – SURE EC meeting Sinaia (8-11 April, 2024) and concluding remarks

**15:00 – 17.00 – Fieldtrip in Bucharest - Blue-green spaces in Bucharest**, from the red communism to the grey post-communism (meeting point the entrance in the Faculty of Geography). University Square – Old Town - Union Square – Metropolitan Cathedral – Union Avenue – Palace of Parliament – Izvor Park

**DESTINATED ONLY TO THE PARTICIPANTS OF THE SURE WORKSHOP**



14:45 – 17:00 Parallel Sessions / Workshops

Room: **Valsan, 3<sup>rd</sup> floor**

Topic: ***E. Challenges of Environment and Human Dimension*** (English session)

Moderators: **Damian Łowicki, Gabriel-Ovidiu Vânău**

**Gabriel-Ovidiu Vânău**; Mihăiță-Iulian Niculae; Viorica Iuliana Miu; Cristiana-Maria Pioarca-Ciocanea, Lavinia-Corina Pîndaru; Ana-Maria Popa; Sorin Avram; Carmen Gheorghe - *Vacaresti Nature Park vs Tineretului Urban Park – visitors profile and perception towards ecosystem services (OP)*

**Athanasios Alexandru Gavriliadis**; Ana-Maria Popa; Diana Andreea Onose; Simona Gradinaru Radulescu - *Planning small for winning big: Small urban green space distribution patterns in an expanding city (OP)*

**Mihaela Clincu** - *A Theoretical Inquiry into the Interplay of Cultural and Creative Industries and Sustainable Development (OP)*

**Damian Łowicki**; Katarzyna Fagiewicz; Małgorzata Stępniewska; Andrzej Mizgajski - *Ecosystem Services Approach on the Way to Implementation – Inside View from Poland (OP)*

**Lidia Poniży** - *Urban agriculture's potential to minimize the effects of climate change in cities from the ecosystem service perspective (PP)*

**Constantin Alexandru Lupuleț**; Cristina Cruceru; Darius-Stefan Nestoriuc - *Neoclassical architecture in the city of Tg. Jiu – component of the cultural landscape and resource for local cultural tourism (PP)*

**Darius-Stefan Nestoriuc**; Constantin Alexandru Lupuleț; Bogdan Petre - *Architecture as an indicator of multiculturalism. Case study the city of Brăila (PP)*

**Teodor-Mihai Rotaru**; Ionuț-Marius Repede - *Cultural Heritage of Northern Prahova - accessibility, visibility, attractivity in the digital era (PP)*



14:45 – 17:00 Parallel Sessions / Workshops

Room: **Mehedinti 3<sup>rd</sup> Floor**

Topic: **B. GIS, Remote Sensing and Geotechnology** (English session)

Moderators: **Alessandra Capolupo, Lucian Roșu**

**Piroska Tóth; Zsófia Kovács; Endre Domokos** - *Water quality index assessment by remote sensing and application of IoT (Internet of things) technology for the mobile monitoring of mountain streams and reservoirs* (OP)

**Ionuț Șandric; Laura Tîrlă; Mirela Vasile; Razvan Popescu; Radu Irimia** - *Mapping retrogressive thaw slumps in Svalbard using SBAS and Sentinel-1 imagery* (OP)

**Alessandra Capolupo; Pietro Marco Santoro; Eufemia Tarantino; Alberico Sonnessa** - *A Tree-Level Hierarchical Model for Detecting Plastic Marine Debris from Medium-Resolution Sentinel-2 Images: the Case Study in the Adriatic Sea off the Coast of Bari* (OP)

**Lucian Roșu; Mihai Bulai** - *A Multidisciplinary Approach for Enhancing Tourism Experience Through VR and AI: A Case Study of the Princely Court of Iași* (OP)

**Maria-Laura Tîrlă; Mirela Vasile; Ionuț Șandric** - *Geomorphological mapping of permafrost and thermokarst landforms in Northern Fennoscandia using Earth observation methods* (OP)

**Piroska Tóth; Zsófia Kovács; Bálint Levente Tarcsay; Dan Traian Ionescu; Endre Domokos** - *Geospatial - Analysis of the environmental pressures of natural factors affecting nutrient pollution of fresh surface waters* (PP)



14:45 – 17:00 Parallel Sessions / Workshops

Room: **Bratescu 3<sup>rd</sup> floor**

Topic: *F. Recent Dynamics and Challenges of Territorial, Economic and Social Processes*

Moderators: **Liliana Dumitrache, Octavian Groza**

**Octavian Groza; Alexandru Rusu; Lilian Niacșu** - *Functional rural areas in Romania: between external polarization and internal homogeneity* (OP)

**Florentina-Cristina Merciu; Mircea Dorobanțu; George-Laurențiu Merciu** - *Perception of the local community regarding the monetization of the historical Oravița-Anina railway as a cultural resource* (OP)

**Irena Roznoviețchi; Paul-Răzvan Șerban; Bianca Mitrică; Laura Lupu** - *Investigating the potential multi-disciplinary research pathways for building socio-economic resilience in Romanian (former)-mining areas* (OP)

**Ion Andronache** - *Fractal Fragmentation Indices - Areas of Applicability* (OP)

**Ana-Irina Lequeux-Dincă; Mihaela Stoenică; Camelia Teodorescu; Adrian-Nicolae Jipa; Iuliana Vijulie; Mihaela Preda** - *Resources for creative cultural tourism development in Bucharest* (OP)

**Mădălina-Teodora Andrei** - *Sustainable urban mobility - a challenge for city planning in the present day* (OP)

**Igor Sîrodoev** - *Socioeconomic Dynamics in the Coastal Area of Romania: Between Long-Term Trends and COVID-19-caused Shocks* (OP)

**Liliana Dumitrache; Mariana Nae; Cristian Cazacu** - *Geographic maldistribution of physician workforce in Romania: urban –rural divide and need for better planning and retention strategies* (OP)

**Mariana Nae; Liliana Dumitrache** –*“Fitinspiration”, recipes and diets in Romanian foods blogs: an exploration of digital foodscapes* (OP)

**Sorin Avram; Laura Anghel; Iulian Niculae** - *Demographic Challenges for the Urban Poles of Economic Growth due to Technological Transformations and Artificial Intelligence* (PP)





14:45 – 17:00 Parallel Sessions / Workshops

Room: **Mihailescu, 4<sup>th</sup> floor**

Topic: *F. Recent Dynamics and Challenges of Territorial, Economic and Social Processes*

Moderators: **Alina Mareci, Andrei Schwab**

**Daria-Petruța Bratu** - *Demographic dynamics of Saxon settlements in Transylvania. Case study: Sighisoara* (PP)

**Vasile-Gabriel Dascălu; Cristian Constantin Drăghici** - *Quantification of the main parameters with a role in the tourist development of the archaeological resources of Dobrogea* (PP)

**George Secăreanu; Andrei Schwab; George Cracu** - *Perspectives on wine-growing areas. A comparative analysis of land use between Argeș County and Galicia Region* (PP)

**Liliana Dumitrache; Mariana Nae; Alina Mareci; Anca Tudoricu; Alexandra Cioclu** - *Perceived barriers in accessing Romanian essential services for vulnerable migrant population* (PP)

**Angelo Andi Petre** - *The spatial allocation of high school network in Romania* (PP)

**Marian-Andrei Vintilă** - *The potential effect of video games on tourism in Romania. Case study: Transylvania-Resident Evil 8* (PP)

**Amalia Mihaela Oglindoiu; Ana-Maria Roangheș-Mureanu** - *Tourism development in Orsova - Dubova area* (PP)

**Mihai Nută** - *The tourist attraction of the Subcarpathian relief between the valley of Ialomița and the valley of Prahova* (PP)

**Iuliana Tudose (Pop)** - *The role of smart tourism in the sustainable development of tourism in EU Member States* (PP)



14:45 – 17:00 Parallel Sessions / Workshops

Room: **406, 4<sup>th</sup> floor**

Topic: *E. Challenges of Environment and Human Dimension*

Moderators: **Mirela Voiculescu, Daniela Strat**

**Cătălina Iticescu; Mirela Voiculescu; Constantin Apetrei; Maxim Arseni; Mădălina Călmuc; Valentina Călmuc; Daniel Constantin; Rodica Efrose; Adrian Roșu; Stefan Petrea; Mihaela Timofti; Cătălina Țopa; Lucian P. Georgescu** - *Rexdan – A Research Infrastructure for Environmental Challenges* (OP)

**Alexandru Gavriș; Mircea Gherghina** - *From (National) Activism to (Localised) Technological Fixes: The Case of the Virgin Forests in Romania* (OP)

**Cristina Toma; Drăghici Constantin Cristian** - *The Geopark - a vehicle for sustainable development*

**Daniela Strat; Simona Mihăilescu** - *Natura 2000 habitats in Romania: pressures and threats* (OP)

**Maria-Alexandra Calotă; Mihai Răzvan Niță** - *Towards Green mobility: A survey on the use of bikes in Romanian cities* (OP)

**Tudor Radu; Ileana Stupariu; Christine Fürst** - *Natura 2000 sites in Carpathian ecoregion: landscape connectivity using multidata (Corine Land Cover/Sentinel 2)* (OP)

**Carmen Ileana Dobrescu; Madalina Aleca; Adela Badulescu** - *Cotroceni National Museum: A new beginning, the digitization of exhibitions, and its online knowledge* (PP)

**Florin-Bogdan Petre; Camelia Teodorescu; Darius-Stefan Nestoriuc; Aurel Gheorghilas; Alexandra Cioclu** - *Housing Affordability and Urban Expansion: A Comparative Analysis of Neighboring Cities to Bucharest, Romania* (PP)

**Mustățea Mihai, Ileana Stupariu** - *The Ciomatu Massif in Harghita County: between high flows of tourists, traditional activities and ecosystems for protected species* (PP)



14:45 – 17:00 Parallel Sessions / Workshops

Room: **Conea 3<sup>rd</sup> floor**

Topic: **H.03 Education Workshop – Bridging the Gaps in Geography Education**

Moderators: **Mioara Clius, Marian Ene**

*Intenția noastră este să avem un dialog despre relația ce trebuie construită între învățământul universitar și preuniversitar în geografie. Scopul nostru este să întărim această relație prin identificarea unor soluții și căi pentru a o îmbunătăți. Un asemenea eveniment are rolul și de a identifica o serie de căi de colaborare în viitor pentru pregătirea geografică a elevilor, pentru creșterea vizibilității științei noastre în Școală și în societate. Nefiind o discuție cu concluzii deja stabilite, orice opinie este binevenită și dorită.*

*Vă propunem o listă de întrebări la care vă invităm să găsim răspunsuri împreună:*

- *De ce pierde Geografia vizibilitatea în Curriculum național deși locul său în mediul social, politic și economic este tot mai evident?*
- *Ce se poate face pentru a întări legăturile dintre mediul universitar și cel preuniversitar?*
- *Ce tipuri de activități sau evenimente am putea realiza împreună pentru a forma geo-competențe elevilor și studenților noștri?*
- *Cum putem construi educația STEAM alături de celelalte științe pentru a spori competențele cheie ale elevilor și rezultatele lor în cadrul testărilor internaționale TIMSS și PISA?*

**Mioara Clius** - *Bridging the Gaps in Geography Education / Reducerea decalajelor în educația geografică*

**Maria-Magdalena Dincă** - *Geography education management / Managementul educației în geografie*

**Daniela Ciută** - *Presentation / Prezentare*

**Florina Păunescu** - *Magurele Summer School – STEM disciplines for carrier development/ Școala de vară de la Măgurele - discipline STEM pentru dezvoltarea în cariera*



14:45 – 17:00 Parallel Sessions / Workshops

Room: **Sala LA, 4<sup>th</sup> floor**

Topic: **B. GIS, Remote Sensing and Geotechnology**

Moderators: **Radu Irimia, Anca Munteanu**

**Anca Munteanu** - *Disappeared tourist attractions on Strada Justitiei, reconstructed in cartographic documents (OP)*

**George-Marius Cracu; Andrei Schvab; Zoia Prefac; Marius Popescu; Igor Sîrodoev; George Secăreanu** - *Pedestrian accessibility to urban parks in the city of Constanța, Romania (OP)*

**Anca Munteanu** - *Changes in the structure of tourist attractions in the Piatra Craiului National Park, reflected in cartographic documents. Curmătura area case study (OP)*

**Alexandra-Diana Bălan** - *The utility of geospatial information in emergency services (OP)*

**Robert Răzvan Dobre; Eduard-Cristian Popescu** - *Assessing hillslope dynamics through morphometric and morphographic analysis of the terrain, using GIS techniques. Case study: Dâmbovița and Prahova Subcarpathians (Curvature Subcarpathians) (PP)*

**Radu Irimia; Ionut Sandric; Viorel Ilinca; Zenaida Chitu; Ion Gheuca** - *Rapid mapping and volume estimation of landslides using UAVs (PP)*

### How you get here

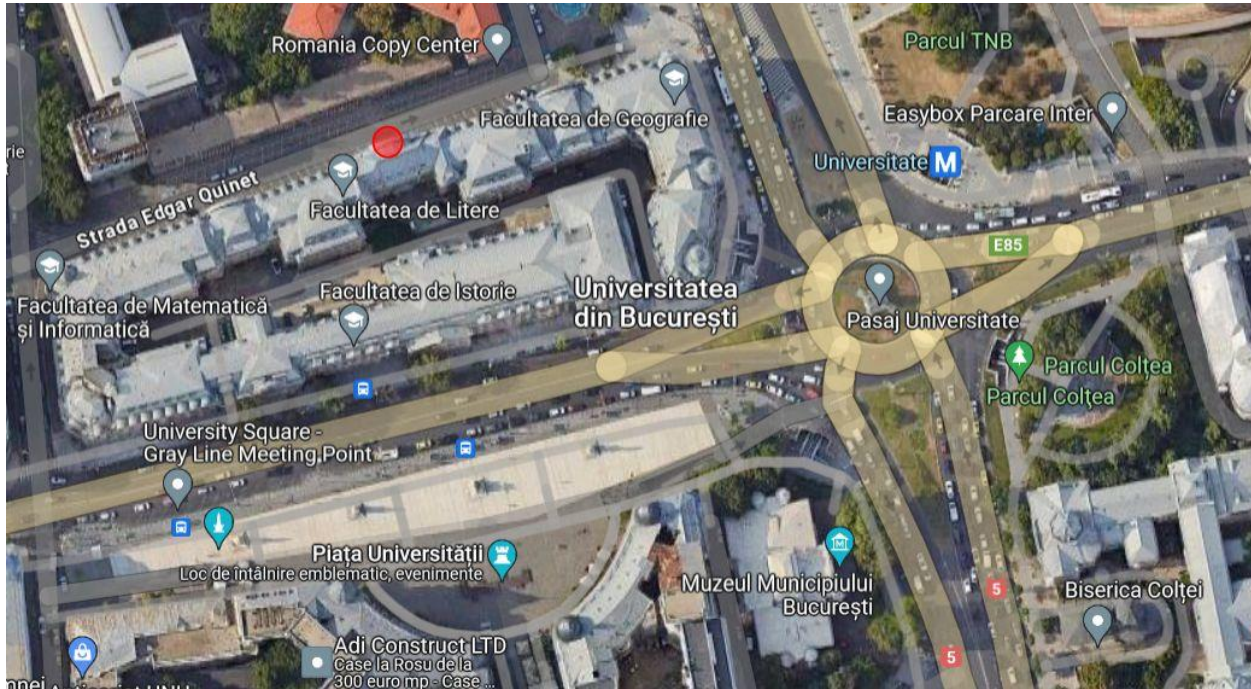

University of Bucharest – Bd. Nicolae Bălcescu Nr. 1, Sector 1, București ● Entrance (Edgar Quinet St.)

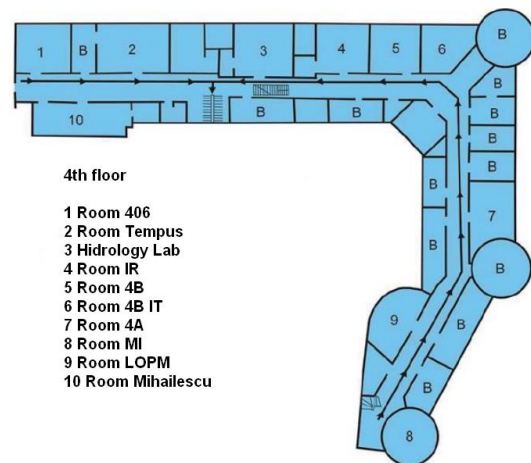
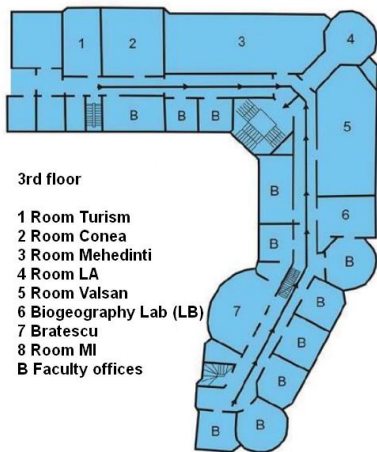

Conference venue: Faculty of Geography, 3<sup>rd</sup> and 4<sup>th</sup> floors





## FIELD TRIPS

### *Sinaia (18<sup>th</sup> November)*

08:00 Meeting point – [Northern Station \(Gara de Nord\)](#) at the main billboard (McDonalds)

08:20 Train to Sinaia Station (IR 1680) – travel time 85 minutes

09:45 Arrival to Sinaia Station

14:00 – 16.00 Lunch break and spare time

16:28 [Sinaia Station](#) - Train back to Bucharest (IRN 12347) – travel time 90 minutes

17:58 Arrival in Bucharest.

#### FIELD TRIP OBJECTIVES:

Royal train station; Sinaia Monastery; The Peles Castle and the Pelisor Castle; Sinaia Casino and Dimitrie Ghica Park; The Stirbei Castle- Sinaia City Museum; Old historical villas tour

The cost for the Peles Castle and train tickets will be 200 LEI per attendee, an amount paid in advance at the registration desk on Friday, 17th of November.

#### IMPORTANT:

- Other additional costs (lunch, snacks, beverages etc.) will be supported exclusively by the participants;
- Given the date and season, we strongly recommend adequate clothing (tracking and impermeable shoes, rain cape, warm clothes)

### *Bucharest (18<sup>th</sup> November)*

10:00 Meeting point – [Faculty of Geography, University of Bucharest](#)

Until 13:00 Walking tour around Bucharest city center with focus on history, planning, green infrastructure, urban dynamics.



## PUBLISHING

If you are interested in publishing the work you present at ECOSMART.23 conference, below we suggest several partner journals you may want to consider. Authors have full responsibility of fulfilling the publishing criteria of the journals. The ECOSMART.23 organizing committee cannot facilitate the publishing of your works in either of the journals.

- ❖ [Analele Universității Din București, Geografie](#)
- ❖ [Human Geographies-Issues](#)
- ❖ [Journal of Environmental & Tourism Analyses](#)
- ❖ [Journal of Urban and Regional Analysis](#)
- ❖ [Revista de Geomorfologie](#)

## ECOSMART 2023 IN A NUTSHELL

The third edition of the *ECOSMART International Conference*, hosted by the Faculty of Geography at the University of Bucharest, brings together **123 presentations** featuring valuable scientific results addressing issues across **7 relevant topics** within the broader domain of Geography. Scholars from major universities and research centers in Romania will engage in debates and discussions, sharing their scientific ideas with peers from Germany, Italy, Turkey, Poland, and Hungary within a professional framework.

The *ECOSMART International Conference* will feature two workshops. The workshop organized by the Society of Urban Ecology (SURE), the leading professional association addressing urban ecology issues, will encourage participants to recognize and formulate current and future paradigm shifts in the domain. The Education Workshop will bring together academic teaching staff and geography teachers from Romania, providing a suitable platform to discuss the challenges that the geography domain faces amidst emerging political and societal changes.

As a result, the organizing committee of the ECOSMART International Conference aims to offer participants a pleasant and fruitful experience between the 17th and 18th of November in Bucharest.